

ALPANO



Raized
real
estate



ALPANO - THE EXCLUSIVE EXPERIENCE

VERBIER, A RENOWNED SKI RESORT OF THE SWISS ALPS WILL SOON WELCOME A CONTEMPORARY ALPINE COMPLEX WHICH WILL BLEND PERFECTLY IN THE MOUNTAINOUS LANDSCAPES OF THE REGION

The project

Alpano is an exceptional residence that exudes comfort and sophistication, with its personalized spaces and panoramic views. Located in the heart of Verbier village, near the prestigious ski resort, it offers an exclusive experience. The project boasts contemporary alpine architecture that perfectly matches the landscape with its clean and pure lines.

The Alpano project comprises 26 luxurious apartments that are sold as primary residences. It offers high-end amenities and services that meet the demands of the most discerning clientele who seek to settle in the prestigious Verbier resort. Its major asset is its orientation that affords breathtaking valley views from every apartment. An underground parking lot will also be built under the building for residents' convenience.

Alpano is designed to fit perfectly into the mountainous landscape of the region thanks to its alpine and pure lines. The architect, native from Verbier, found its inspiration from a painting depicting the village and aimed to honor its essence while also incorporating modern amenities for luxurious living. Every detail and finish have been thought out with particular care for a most exclusive experience.

Situation

Verbier village provides privileged access to one of the most prestigious ski resorts. Voted the best ski resort in the world in 2021, Verbier is renowned for its high-end services, lively nightlife, and exceptional ski area.

This resort stretches across a vast sunny plateau, offering unobstructed views of the valley and surrounding Alpine peaks. It perfectly combines exceptional services, lush nature, and mountain sports.

In winter, its outstanding ski area provides an infinite playground for snow sports. In summer, a large number of marked trails will satisfy mountain biking and hiking enthusiasts.

Families, young people, and seniors will find happiness in this alpine village, which offers a wide range of activities, including paragliding, hiking, heli-skiing, sledding, golf, and museums.

The Alpano project is ideally located 5 minutes by car from the center of the resort and is also very well-served by public transport.

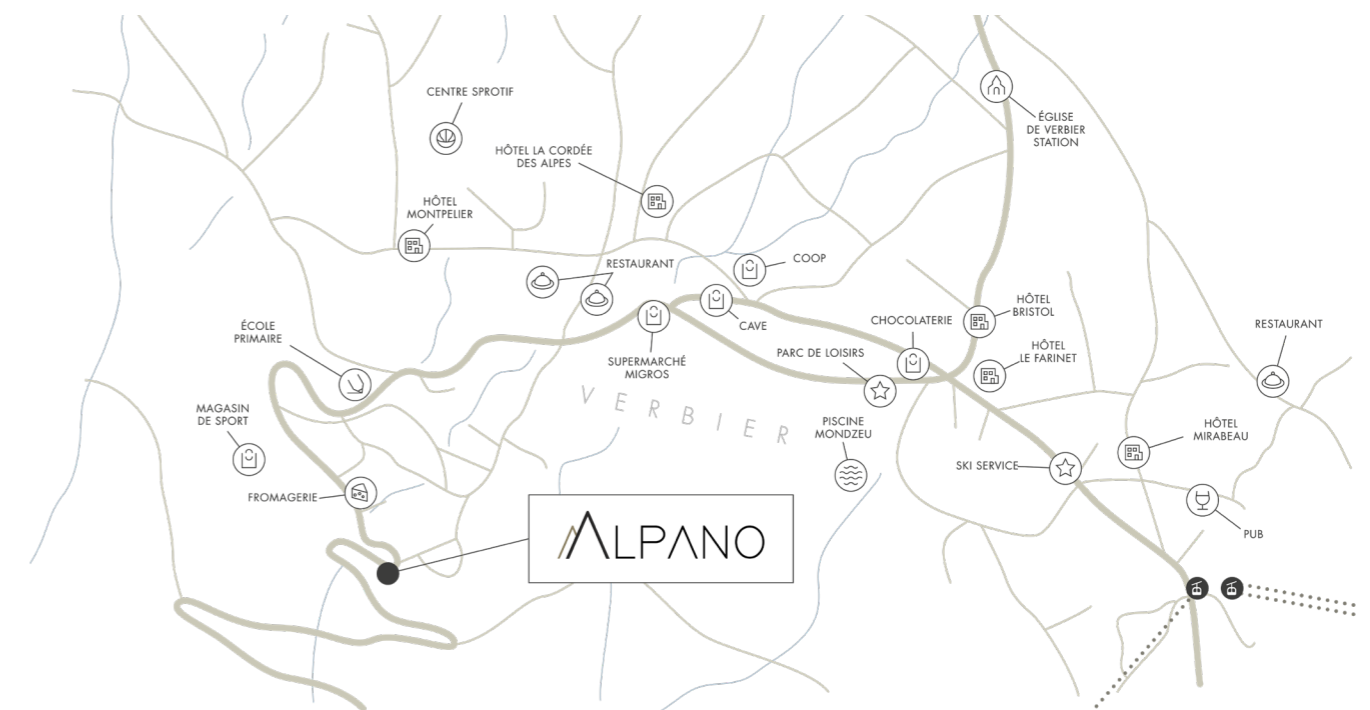

BUS STOP

60

METERS

CITY CENTER
& SHOPS

9

MINUTES WALK

CITY CENTER
& SHOPS

2

MINUTES BY CAR

SKI LIFT

5

MINUTES BY CAR

Sustainability

Sustainable construction is essential for Raized, the developer of the project. With Alpano, they aim to comply with their sustainable construction strategy, and have mandated Osmia, a consulting firm specializing in integrating sustainability criteria into real estate projects, to assist them. The Alpano project targets the following objectives:

- Incorporate bioclimatic factors into the building's design
- Measure and optimize the building's greenhouse gas emissions and grey energy through the architectural concept, waste management, and material choices
- Avoid using substances harmful to the environment or health in the choice of materials for second work and finishing work
- Promote a circular economy by working with local suppliers and contractors and by planning effective waste management
- Offer a sober energy approach
- Focus on users' comfort and health
- Minimize risks for fauna and flora and integrate measures promoting biodiversity

The project aims to achieve the CEEB A/A class of the cantonal energy certificate for buildings, the highest category in terms of energy efficiency and insulation. The STEEN system, for heat production and cooling, have been integrated into the project for a renewable energy supply. Energy monitoring and facilitated electric vehicle supply will help users minimize their energy consumption.

This project will also integrate the Raized Art program established by the developer. This program will support the local art scene by commissioning an original work of art designed for the building by a Swiss artist. This artistic intervention offers a unique and poetic dimension to the buildings and promotes the cultural sector and Swiss art scene. (p. 18)

Flats

The apartments are tailor-made to offer customized amenities and comfort that reflect your personal style. A contemporary design dominates the interiors, while touches of wood provide a warm and comfortable atmosphere. These living spaces have been intelligently designed to optimize space and integrate with the building's lines. Each apartment benefits from a valley view and ample natural light thanks to its southern exposure.

For each apartment, we offer high-quality finishes, eco-friendly options, and a range of materials that the future buyer can choose from. This personalized approach ensures optimal quality of life and a unique interior design.







List of flats

Floor 0

	Rooms	Flat	Balcony	Terrace	Weighted surface area
001	1	32.9 m ²	4 m ²	-	34.9 m ²
002	1	28.4 m ²	4 m ²	-	30.4 m ²
003	1	31.4 m ²	4 m ²	-	33.4 m ²
004	1	43.6 m ²	4 m ²	-	45.6 m ²
005	1	40.9 m ²	-	6.3 m ²	43.0 m ²
006	1	43.8 m ²	-	11.4 m ²	47.6 m ²
007	1	36.7 m ²	-	10.9 m ²	40.3 m ²
008	1	36.3 m ²	-	10.8 m ²	39.9 m ²
009	1	36.2 m ²	-	10.7 m ²	39.7 m ²
010	1	37.2 m ²	-	11.1 m ²	40.8 m ²
011	2.5	82.7 m ²	-	24.3 m ²	90.7 m ²

*Informations remises avec les réserves d'usage



List of flats

Floor 1

	Rooms	Flat	Balcony	Terrace	Weighted surface area
101	2.5	69.8 m ²	-	44.2 m ²	84.4 m ²
102	3.5	87.9 m ²	-	73.2 m ²	112.1 m ²
103	4.5	121.4 m ²	16.3 m ²	33.9 m ²	140.7 m ²
104	3.5	123.3 m ²	34.5 m ²	-	140.6 m ²
105	4.5	148.9 m ²	18.7 m ²	-	158.3 m ²

*Informations remises avec les réserves d'usage



List of flats

Floor 2

	Rooms	Flat	Balcony	Terrace	Weighted surface area
201	4.5	122.4 m ²	-	51.0 m ²	139.2 m ²
200.1	1	24.1 m ²	-	-	24.1 m ²
200.2	1	30.6 m ²	-	-	30.6 m ²
202	3.5	85.7 m ²	-	33.9 m ²	96.9 m ²
203	3.5	99.8m ²	-	25.4 m ²	108.2 m ²
204	4.5	143.6 m ²	14.9 m ²	27.7 m ²	152.7 m ²

*Informations remises avec les réserves d'usage



List of flats

	Rooms	Flat	Balcony	Terrace	Weighted surface area
301	5.5	190.1 m ²	42.0 m ²	45.8 m ²	226.2 m ²
302	5.5	189.6 m ²	45.2 m ²	-	212.2 m ²
303	6.5	214.4 m ²	32.5 m ²	-	230.7 m ²
304	6.5	209.8 m ²	32.9 m ²	-	226.3 m ²

*Informations remises avec les réserves d'usage

Floor 4



Floor 3

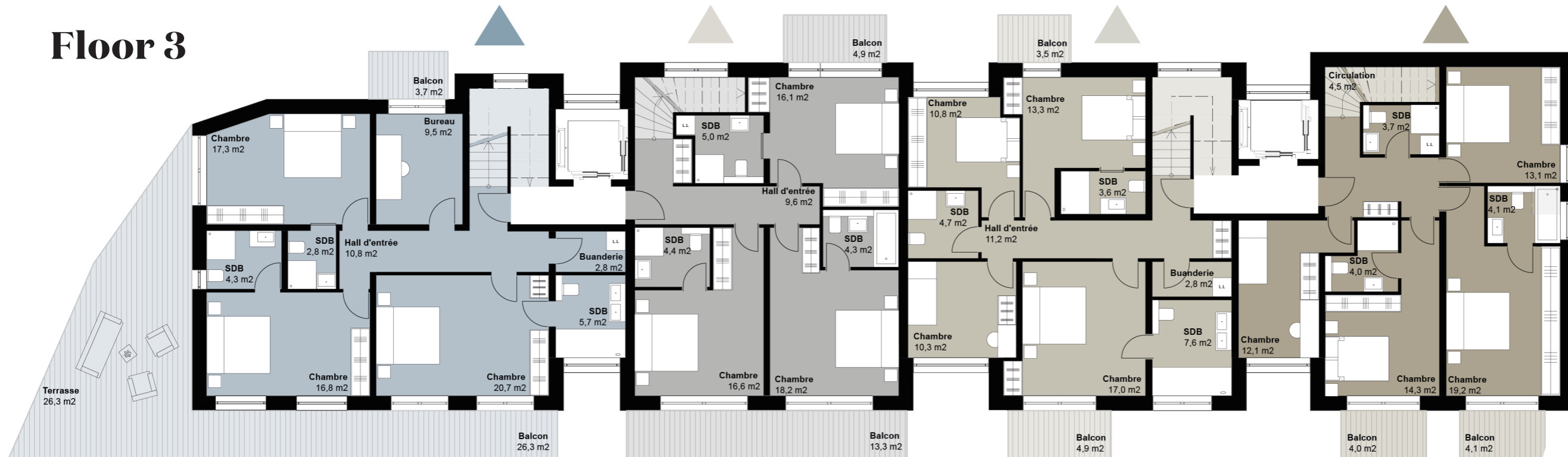

A commitment to culture



Xavier Veilhan et Olivier Mosset pour plateforme10

Raized art

For each real estate development project, Raized Real Estate allocates a percentage of the construction cost to an artistic piece in order to improve the experience of visitors and the quality of life of future inhabitants, to support the local artistic scene and raise awareness of art among a wide audience.

Raized Art allows art and architecture, intimately linked, to meet and give a particular dimension to its projects. Through an artistic creation in our buildings, Raized Art gives everyone the opportunity to live in direct proximity to a work of art.

A responsible commitment

We aim for excellence in sustainability by 2025, in terms of how we operate as a company and handle our projects. Raized wants to build responsibly whilst integrating environmental and social sustainability factors into all its upcoming projects.

Raized is committed to donating a percentage of its project margin to organizations aligned with the UN Sustainable Development Goals and our values.



Contact

**Raized
real
estate**



Raized Real Estate SA

Rue du Rôtillon 8,
1003 Lausanne
+41 21 799 90 90
info@raized.ch
www.raized.ch



Quentin Trieule
Project developer
Raized Real Estate
+41 76 681 14 27

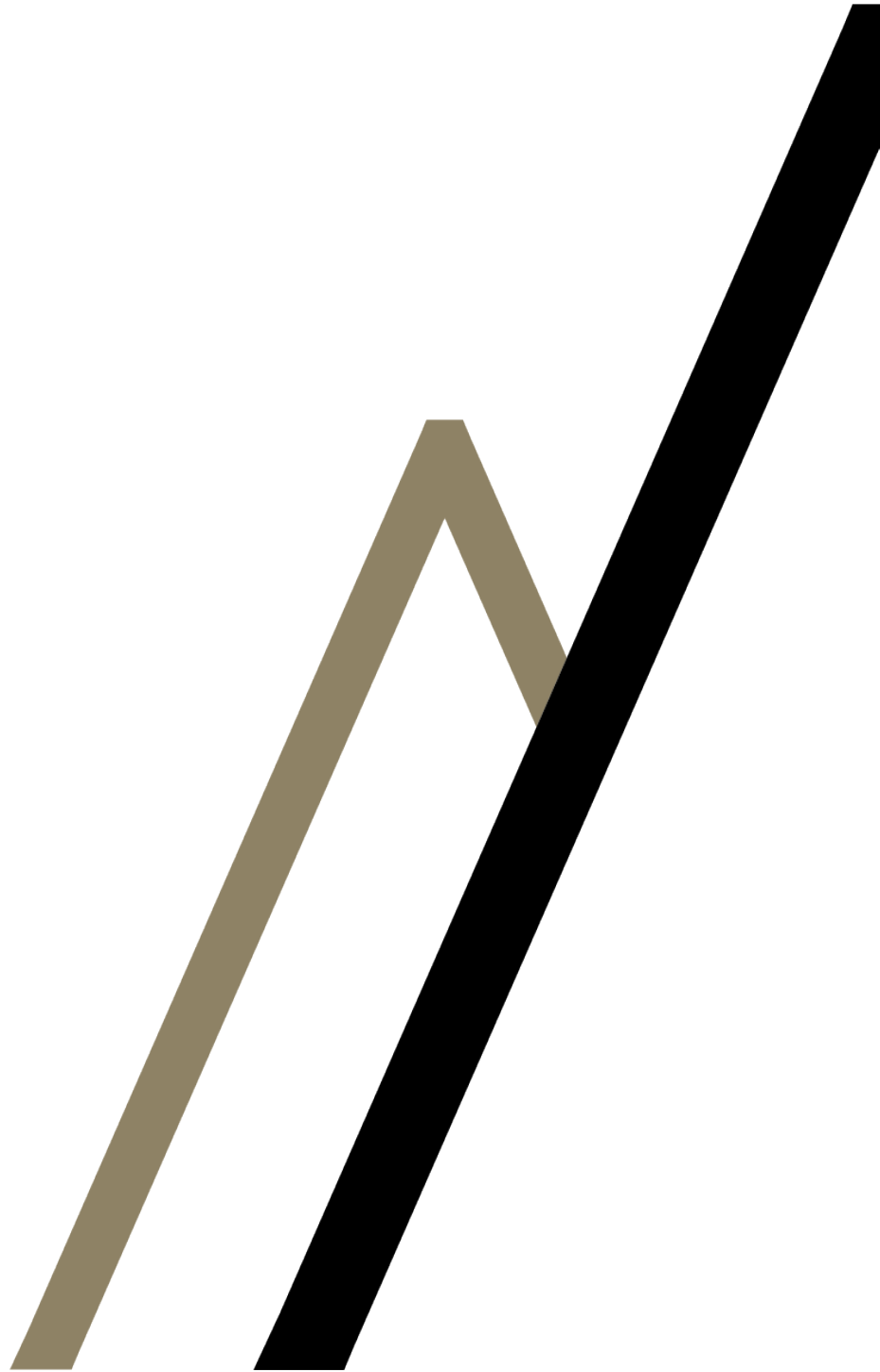

Raized
real
estate